



Style 1118-0226
Work Order 1567



It's like having your own shop!

Drawn By: Chris Davis

Last Modified: February 18, 2026

Style 1118-0226

Work Order 1567

Wood: Maple

Color: White Lacquer

Size: Queen

Hardware: 15" Black Bar Pulls for face and large door

6" Black Bar Pulls everywhere else

Info Page



It's like having your own shop!

Style 1118-0226

Work Order 1567

REVISIONS

	MM/DD/YY	REMARKS
1	1/13/26	Add charging station to BC and Desk, add lights
2		to hutch 7 at \$30 ea., add hutch switch (\$35),
3		add printer pullout to bookcase, changed hwd.
4	1/16/26	Changed outlets and lights to black.
5	--/--/--	...

02

A

Style 1118-0226
Work Order 1567

Size: Queen

Wood: Maple

Color: White Lacquer

Hardware: 15" Black Bar Pulls for face and large door
6" Black Bar Pulls everywhere else

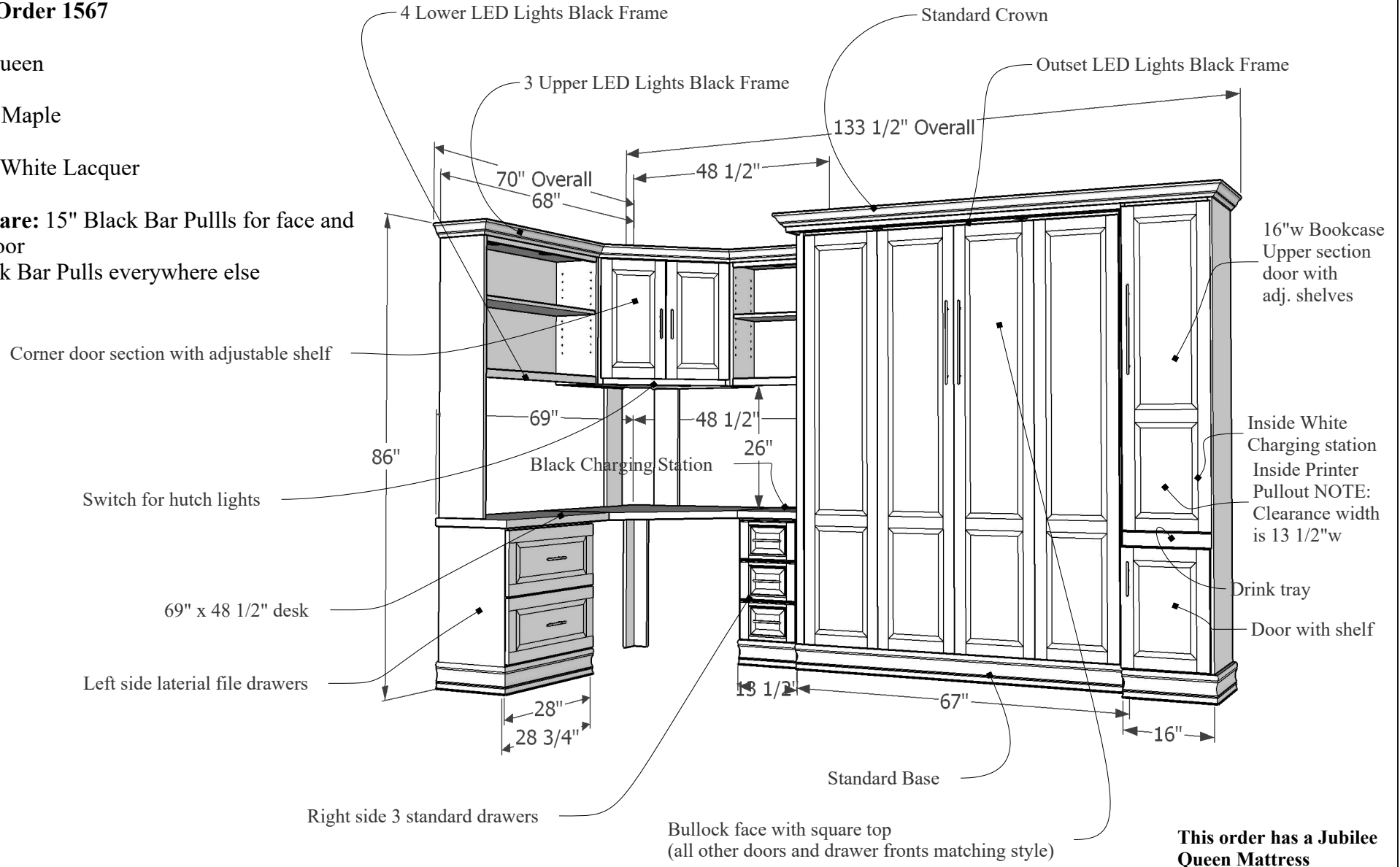

This order has a Jubilee Queen Mattress

Main Drawing with Measurements



It's like having your own shop!

Style 1118-0226
Work Order 1567

REVISIONS

	MM/DD/YY	REMARKS
1	1/13/26	Add charging station to BC and Desk, add lights
2		to hutch 7 at \$30 ea., add hutch switch (\$35).
3		add printer pullout to bookcase, changed hwd.
4	1/16/26	Changed outlets and lights to black.
5	--/--/--	...

03

A

Style 1118-0226
Work Order 1567
 Queen
 White Lacquer

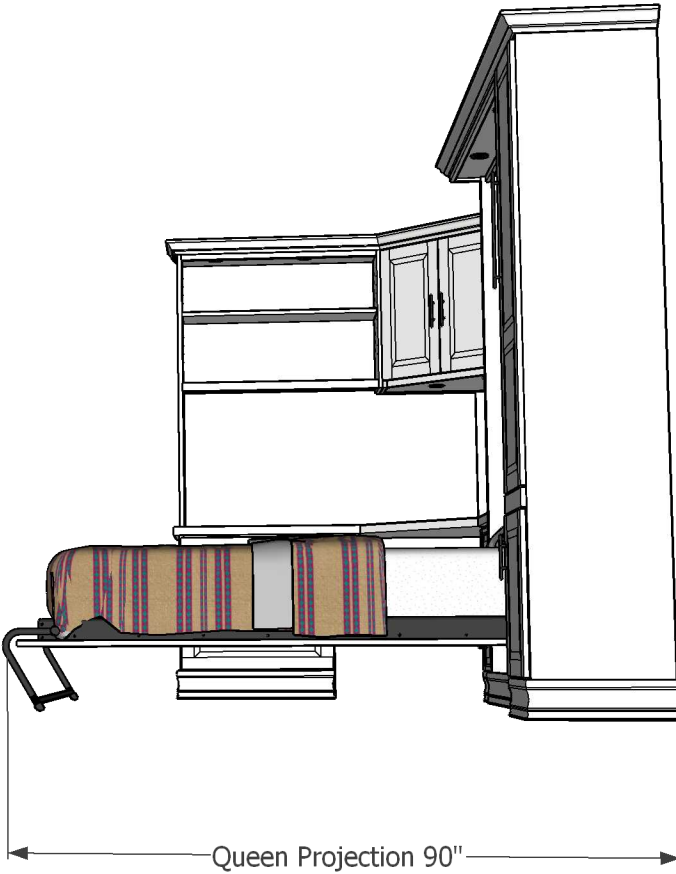

Drawing Projection



It's like having your own shop!
 Style 1118-0226
 Work Order 1567

REVISIONS		
	MM/DD/YY	REMARKS
1	1/13/26	Add charging station to BC and Desk, add lights
2		to hutch 7 at \$30 ea., add hutch switch (\$35),
3		add printer pullout to bookcase, changed hwd.
4	1/16/26	Changed outlets and lights to black.
5	--/--/--	...

A 04



Face Closed



It's like having your own shop!

Style 1118-0226
Work Order 1567

REVISIONS

	MM/DD/YY	REMARKS
1	1/13/26	Add charging station to BC and Desk, add lights
2		to hutch 7 at \$30 ea., add hutch switch (\$35),
3		add printer pullout to bookcase, changed hwd.
4	1/16/26	Changed outlets and lights to black.
5	--/--/--	...

A 05

A



Face Open



It's like having your own shop!

Style 1118-0226
Work Order 1567

REVISIONS

	MM/DD/YY	REMARKS
1	1/13/26	Add charging station to BC and Desk, add lights
2		to hutch 7 at \$30 ea., add hutch switch (\$35),
3		add printer pullout to bookcase, changed hwd.
4	1/16/26	Changed outlets and lights to black.
5	--/--/--	...

A 06



Desk



It's like having your own shop!

Style 1118-0226
Work Order 1567

REVISIONS

	MM/DD/YY	REMARKS
1	1/13/26	Add charging station to BC and Desk, add lights to hutch 7 at \$30 ea., add hutch switch (\$35).
2		
3		add printer pullout to bookcase, changed hwd.
4	1/16/26	Changed outlets and lights to black.
5	--/--/--	...

A 07

Base Molding Cutout

Bookcase is spaced a couple inches away from wall to allow for wiring.

Bed will sit flush with back wall

6" high cutout for room's base molding

Base cutout

6"

Base Molding Cutout



It's like having your own shop!

Style 1118-0226
Work Order 1567

REVISIONS

	MM/DD/YY	REMARKS
1	1/13/26	Add charging station to BC and Desk, add lights
2		to hutch 7 at \$30 ea., add hutch switch (\$35).
3		add printer pullout to bookcase, changed hwd.
4	1/16/26	Changed outlets and lights to black.
5	--/--/--	...

08

A



Drink Trays



It's like having your own shop!

Style 1118-0226
Work Order 1567

REVISIONS

	MM/DD/YY	REMARKS
1	1/13/26	Add charging station to BC and Desk, add lights to hutch 7 at \$30 ea., add hutch switch (\$35),
3		add printer pullout to bookcase, changed hwd.
4	1/16/26	Changed outlets and lights to black.
5	--/--/--	...

09

A



Lights



It's like having your own shop!

Style 1118-0226
Work Order 1567

REVISIONS

	MM/DD/YY	REMARKS
1	1/13/26	Add charging station to BC and Desk, add lights to hutch 7 at \$30 ea., add hutch switch (\$35).
2		
3		add printer pullout to bookcase, changed hwd.
4	1/16/26	Changed outlets and lights to black.
5	--/--/--	...

A 10



Bookcase Open



It's like having your own shop!
 Style 1118-0226
 Work Order 1567

REVISIONS

	MM/DD/YY	REMARKS
1	1/13/26	Add charging station to BC and Desk, add lights to hutch 7 at \$30 ea., add hutch switch (\$35),
2		add printer pullout to bookcase, changed hwd.
3		
4	1/16/26	Changed outlets and lights to black.
5	--/--/--	...



NOTE: Printer pullout tray will 12 1/2"w x 14"d. (the clearance on the width will be 13 1/2".)

Printer Pullout



It's like having your own shop!

Style 1118-0226
Work Order 1567

REVISIONS

	MM/DD/YY	REMARKS
1	1/13/26	Add charging station to BC and Desk, add lights to hutch 7 at \$30 ea., add hutch switch (\$35),
2		add printer pullout to bookcase, changed hwd.
3		Changed outlets and lights to black.
4	1/16/26	
5	--/--/--	...



Light touch plate

Headboard



It's like having your own shop!

Style 1118-0226
Work Order 1567

REVISIONS

	MM/DD/YY	REMARKS
1	1/13/26	Add charging station to BC and Desk, add lights
2		to hutch 7 at \$30 ea., add hutch switch (\$35),
3		add printer pullout to bookcase, changed hwd.
4	1/16/26	Changed outlets and lights to black.
5	--/--/--	...

More Extras

More extras can be added to your murphy bed design. Examples of those can be found at:

www.wwbeds.com/murphy-bed-extras



More Extras



It's like having your own shop!

Style 1118-0226

Work Order 1567

REVISIONS

	MM/DD/YY	REMARKS
1	1/13/26	Add charging station to BC and Desk, add lights
2		to hutch 7 at \$30 ea., add hutch switch (\$35),
3		add printer pullout to bookcase, changed hwd.
4	1/16/26	Changed outlets and lights to black.
5	--/--/--	...